

# HUAWEI *Ascend* P7

## Quick Start Guide



# Your phone at a glance

Thank you for choosing **HUAWEI Ascend P7**.

Before you start, let's take a look at your new phone.

Press the power button to turn on or turn off the screen.

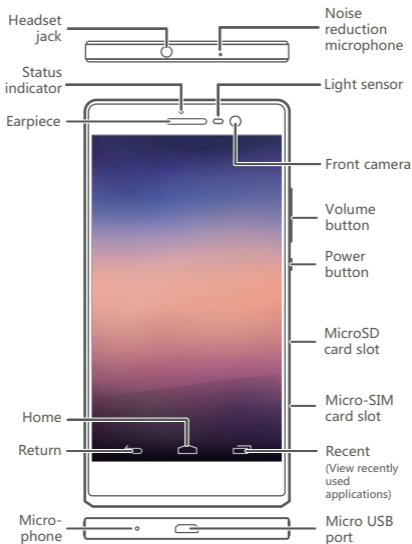

# Installing the micro-SIM card

 Exercise caution when using the SIM eject tool to avoid injury or damaging your phone. Keep it away from children.

Follow the instructions in the figures below to install your micro-SIM card and microSD card. Then press and hold the power button to power on your phone.

1

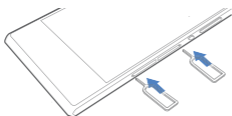

2

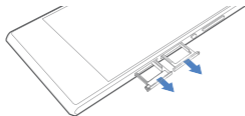

3

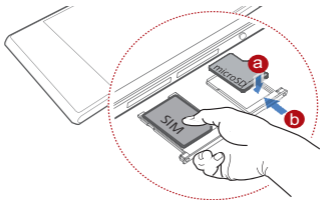

# Locking and unlocking the screen

Press the power button to lock the screen.

Your phone automatically locks its screen after being idle for a specified period of time. You can touch  > **Display** > **Sleep** to set the screen timeout period.

If the screen is off, press the power button to turn it on. Slide your finger toward any direction to unlock the screen.



# Calling

Touch  and enter a phone number on the dialer. Your phone then displays matching contacts. Touch a contact to place a call.

Alternatively, touch  and enter the initials or first few letters of a contact's name to quickly find the contact. From the displayed matching contacts, touch the contact you want to call.

You can also touch a number from Messaging, Email, or Browser to place a call.

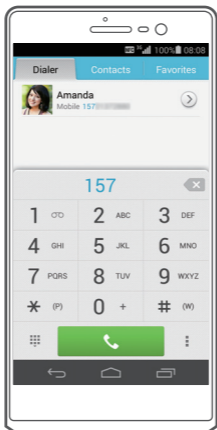

# Messaging

Touch  to open **Messaging**.

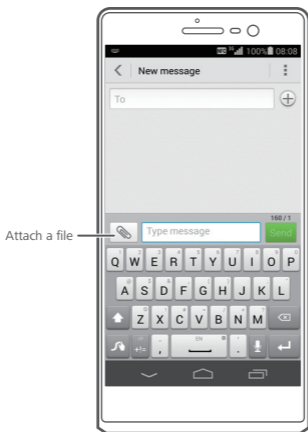

Attaching a file to a text message converts the message into a multimedia message. You can save photos, audio clips, or videos from received multimedia messages.

When you are typing, flick down from the status bar to open the notification panel, and touch  to switch the input method.



# Camera

Touch  to launch **Camera**.



Frame the scene you want to capture, and have the phone automatically focus itself or touch the screen to focus on a specific object. Touch  to take a photo or touch  to shoot a video.

-  When the screen is locked, press the volume down button twice quickly to launch the camera and take a photo.



# Suspend button

The suspend button contains a variety of useful functions and shortcuts, which lets you quickly configure your phone settings or launch applications.

Go to  and touch **Suspend button** to turn on the suspend button. Touch  to display the suspend button menu.

Touch  to display the multi-window menu. You can then launch commonly used tools without leaving the current screen.

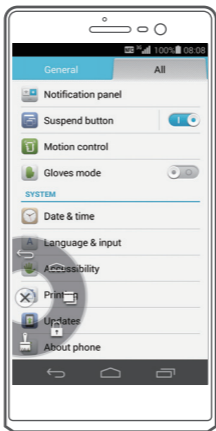



# Phone Manager

**Phone Manager** can help you manage application permissions, optimize the system, clean up your storage, and save battery power.

Touch  to open **Phone Manager**.

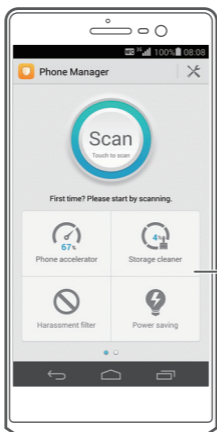

Flick left  
for more  
functions

# Multi-screen display

You can connect your phone to other displays to synchronize content on your phone to those displays and control the playback.

Open the notification panel and turn on Multi-screen by touching . You can then display photos or play videos and audio clips from your phone on a TV or projector. To do so requires that your TV support DLNA. If it doesn't, you can purchase the HUAWEI MediaQ or a similar wireless transmission device.



# More information

For the full user guide, go to

<http://consumer.huawei.com/en/> and search for P7.

## **Want to learn more about Huawei Emotion UI?**

Visit <http://en.ui.vmall.com/> for the latest information.

-  This guide is for reference only. The actual product, including but not limited to the color, size, and screen layout, may vary. All statements, information, and recommendations in this guide do not constitute a warranty of any kind, express or implied.



For DTS patents, see <http://patents.dts.com>. Manufactured under license from DTS Licensing Limited. DTS, the Symbol, & DTS and the Symbol together are registered trademarks, and DTS Sound is a trademark of DTS, Inc. © DTS, Inc. All Rights Reserved.

Please visit  
[www.huaweidevice.com/worldwide/support/hotline](http://www.huaweidevice.com/worldwide/support/hotline)  
for recently updated hotline and email address in your  
country or region.

Model: HUAWEI P7-L10



31010RDD\_01